

**Material Alterations as defined in Texas Gov't Code §2306.6712(d) (2), (4), and (6) and 10 TAC §10.405(a)(4)(B), (D), and (F)**

**Application**

Density: 14.30 units/acre (146 units on a 10.21-acre tract)

Unit Mix:

1/1 – 26 units

2/1 – 76 units

3/1.5 – 44 units

Net Rentable Area (NRA): 159,676 square feet

Parking Spaces: 172 on-site and 13 street/cul-de-sac parking spaces

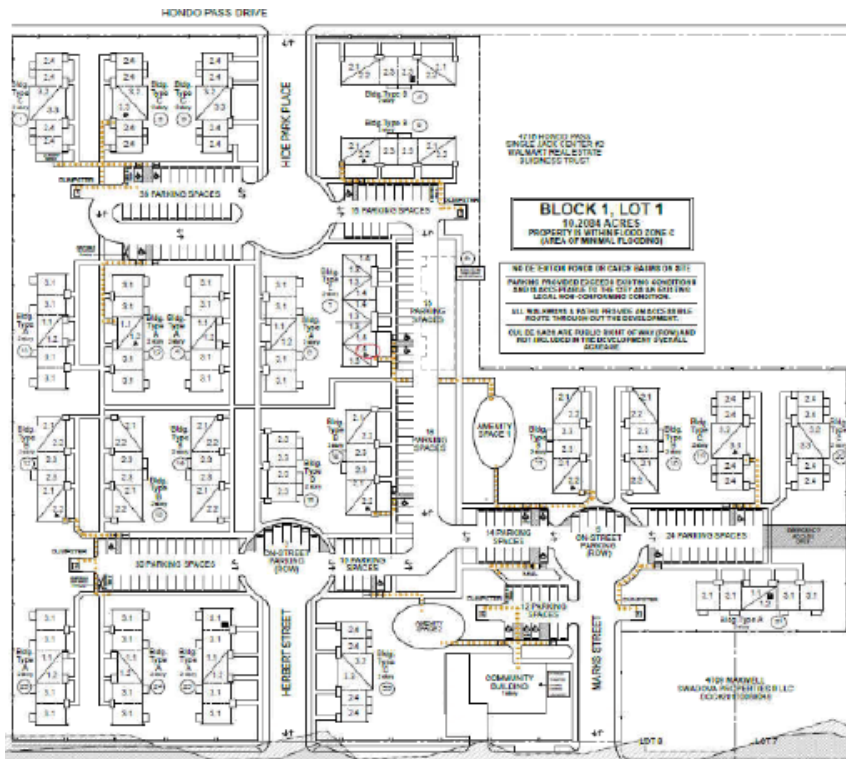

**Amendment**

Density: 13.483 units/acre (146 units on a 10.8281-acre tract)

Unit Mix:

1/1 – 25 units

2/1 – 78 units

3/1.5 – 43 units

NRA: 149,894 square feet (reduction of 9,782 square feet or 6.13%)

Parking Spaces: 195 on-site parking spaces

